

# BMW R1100/1150GS FRONT AND REAR WS-520 INSTALLATION INSTRUCTIONS

**TOOL NEEDED: 4 MM ALLEN WRENCH**

To prepare your new Sargent World Sport Seat for mounting, you will need to remove your stock mounting brackets from your current seats, both front and rear and mount it onto your new World Sport Performance Seat.

This will only require about 5 minutes of your time and a 4 MM Allen wrench.

## FRONT SEAT

Remove the 4 bolts from your OEM seat as shown in the diagram. In most cases, the bolts and bushings will remain in place on the bracket when removed but take care to insure none fall away when it is removed from the pan. A detailed close up of the order in which they should be reassembled is shown in the inset (fig 1). Now reassemble the mounting bracket onto your new Sargent Seat and snug the bolts secure.

## REAR SEAT

Remove the 2 bolts and latching wire from your OEM rear seat and install them onto your new Sargent Seat as shown in the insert at the left and snug the bolts secure. (fig 2.)

Mount your new Sargent Seats to your motorcycle and your ready to ride!

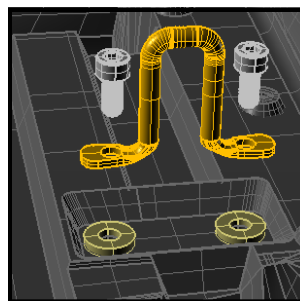
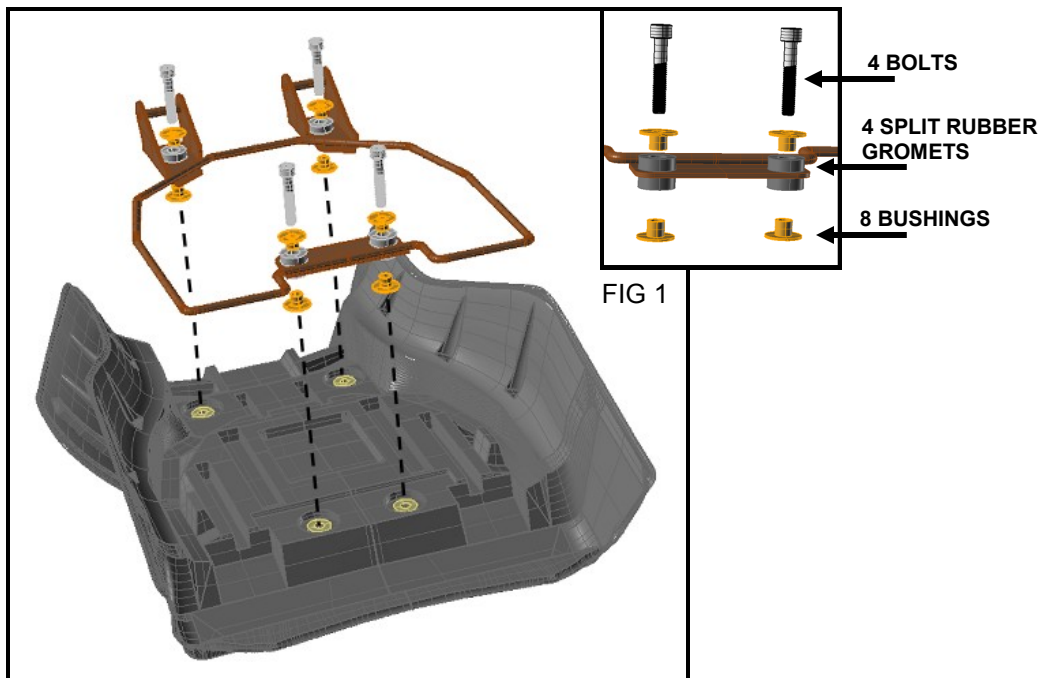

**SARGENT**  
CYCLE PRODUCTS

1-800-749-SEAT FAX 904-354-7979  
WWW.SargentCycle.COM